



# AMERICAN MOUNTAINEERING CENTER

GOLDEN, COLORADO

**Location:** 710 10th Street  
Golden, CO 80401

**Building:** 47,122 SF

**Available:** 11,000 SF. (+/-)

**Year Built:** 1924

**Updated:** 2001

**Highlights:**

- > State-of-the-art Museum
- > American Alpine Club Library
- > Indoor climbing wall
- > 350-seat auditorium/movie theater
- > 200-person conference center
- > Classrooms
- > On-site parking

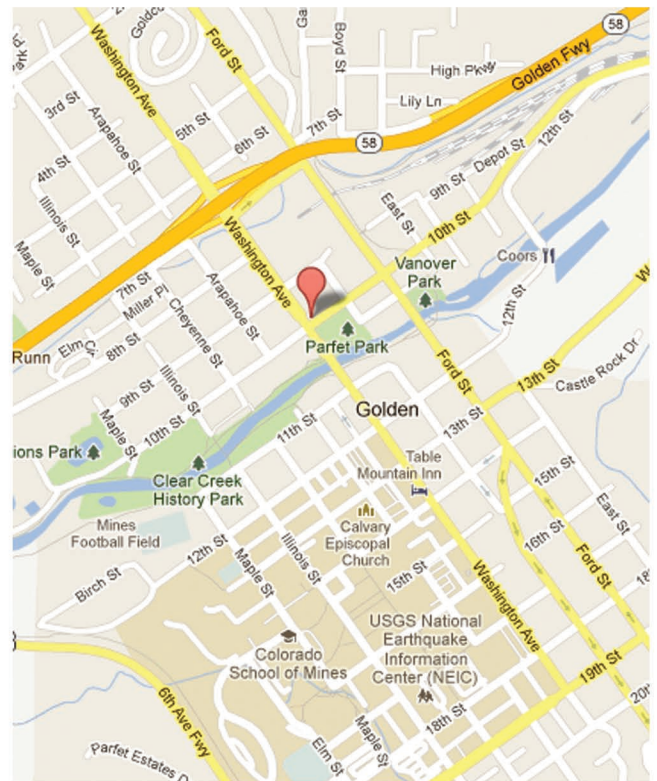

## THE AMC:

In 1993, The American Alpine Club and the Colorado Mountain Club jointly purchased the historic Golden High School building in Golden, Colorado. The clubs completed a \$4.2 million renovation of the building that is now the American Mountaineering Center — the nation's premier facility for research, education and information about the mountain environment. Support for the project has come from club members, the outdoor industry, and local foundations, including the Golden Civic Foundation.



## THE AREA:

Nestled at the base of the foothills, Golden, Colorado is a scenic city with a vibrant downtown and easy access to both Denver and the mountains. Established in the mid-19th century, Golden has grown from a small mining supply town to a lively community. The AMC, which sits across from Parfet Park on the main downtown strip, is walking distance from shops, restaurants, cafes, hotels, and cultural attractions. Enjoy easy access to biking and running trails, catch a tour at the MillerCoors Brewery, or walk around the Colorado School of Mines campus.



## THE OWNING ORGANIZATIONS:



Founded in 1902, The American Alpine Club is a national nonprofit organization dedicated to promoting climbing knowledge, conserving mountain environments, and serving the international climbing community.



The Colorado Mountain Club is the premier outdoor conservation, education, and recreation organization in Colorado. Founded in 1912, CMC provides comprehensive and diverse programs and activities revolving around human-powered outdoor recreation, science, history, stewardship, safety, policy, arts and culture.



### THE MUSEUM

The Bradford Washburn American Mountaineering Museum, located on the main level of the building, opened its doors in February 2008 as America's first and only museum dedicated to the heroism, technology, culture and spirit of mountaineering. A joint venture of the American Alpine Club, the Colorado Mountain Club and the National Geographic Society, this 3,500 square-foot museum houses interactive exhibits, unique artifacts and a large-scale model of Mt. Everest.



### THE LIBRARY

The Henry S. Hall Jr. American Alpine Club Library is an internationally known resource on alpinism, climbing, and mountain regions and cultures. Established in 1916, it is one of the oldest alpine research facilities in the United States, with a circulating collection of nearly 20,000 books and videos devoted to mountaineering and rock climbing.



### FOSS AUDITORIUM

The 350-seat auditorium/movie theatre offers upgraded audio/visual equipment and a stage for presentations and performances.



### THE CLIMBING WALL

The Center houses a 30-foot indoor rock-climbing wall, with classes and open climbs coordinated by the Colorado Mountain Club.



### CONFERENCE SPACE & MEETING ROOMS

As one of Golden's top rental venues, our versatile 200-person conference center is used for classes, conferences, workshops, weddings and more. The Center also has two smaller meeting rooms on the top floor that are available for event rentals.

## AMC SPACE FOR LEASE

**Total Available Space:**  
up to 11,000 SF

**Main Level:**  
2340 SF (+/-)

**Annex Level:**  
2813 SF (+/-)

**Garden Level:**  
3563 SF (+/-)

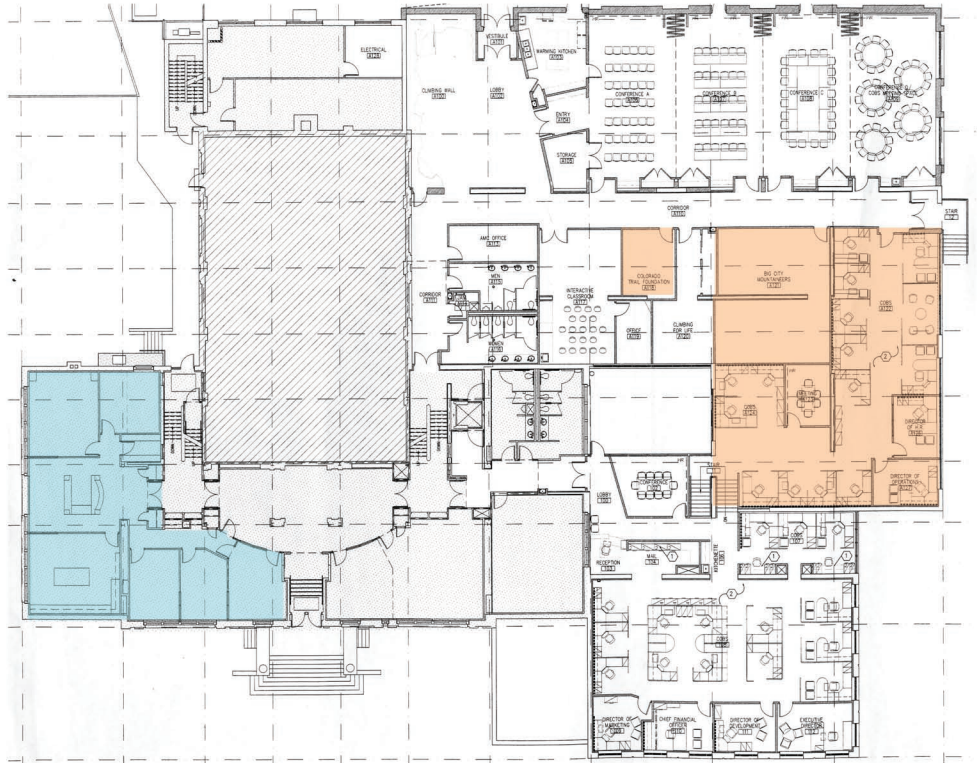

**Lease Range:**  
\$16-\$20 per SF

**Price and space negotiable.**

Final layouts & configurations subject to change.

